

BC Land Surveyor's Site Plan of:  
Lot 16 and 17, Block B, Section 11,  
Esquimalt District, Plan 292, Except  
Parcel A (DD 130301).  
P.I.D.'s: 001-322-818 & 001-322-842

Civic Address: 527 Lampson Street



Scale = 1:200

Dated this 13th day of May, 2025.

Distances and elevations shown are in metres.

Elevations are based on geodetic datum CVD28BC  
and derived from OCM 84H0162.

This site plan is for building and design purposes and is  
for the exclusive use of our client.

This document shows the relative location of the surveyed  
structures and features with respect to the boundaries of  
the parcel described above. This document shall not be used  
to define property lines or property corners.

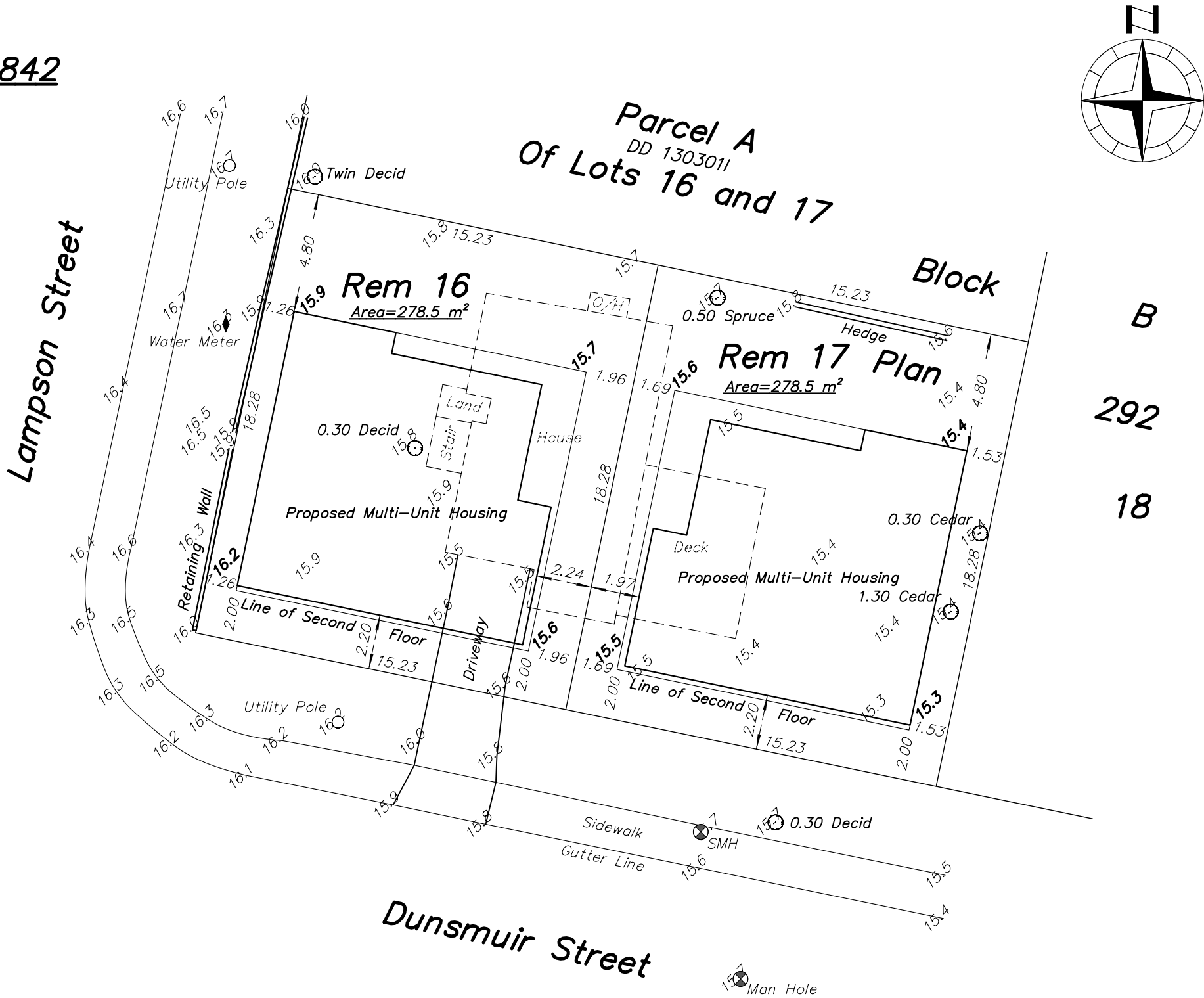

Wey Mayenburg Land Surveying Inc.

[www.weysurveys.com](http://www.weysurveys.com)

#4-2227 James White Boulevard  
Sidney, BC V8L 1Z5  
Telephone (250) 656-5155  
File: 250108\Sit\LE