

BC Land Surveyors Site Plan

Civic: 1004 Gosper Crescent

Legal: Lot 20, Block 2, Section 10,
Esquimalt District, Plan 11214

Parcel Identifier: 000-225-754 in the Township of Esquimalt

Scale: 1:200

Distances are in metres.

The intended print size is 11" by 17".



Legend

Elevations are geodetic and referenced to the CVD288C datum.

+ ## - denotes - existing elevation

Lot area: 666 m²

Non-financial charges affecting title

215690C - Right of Way

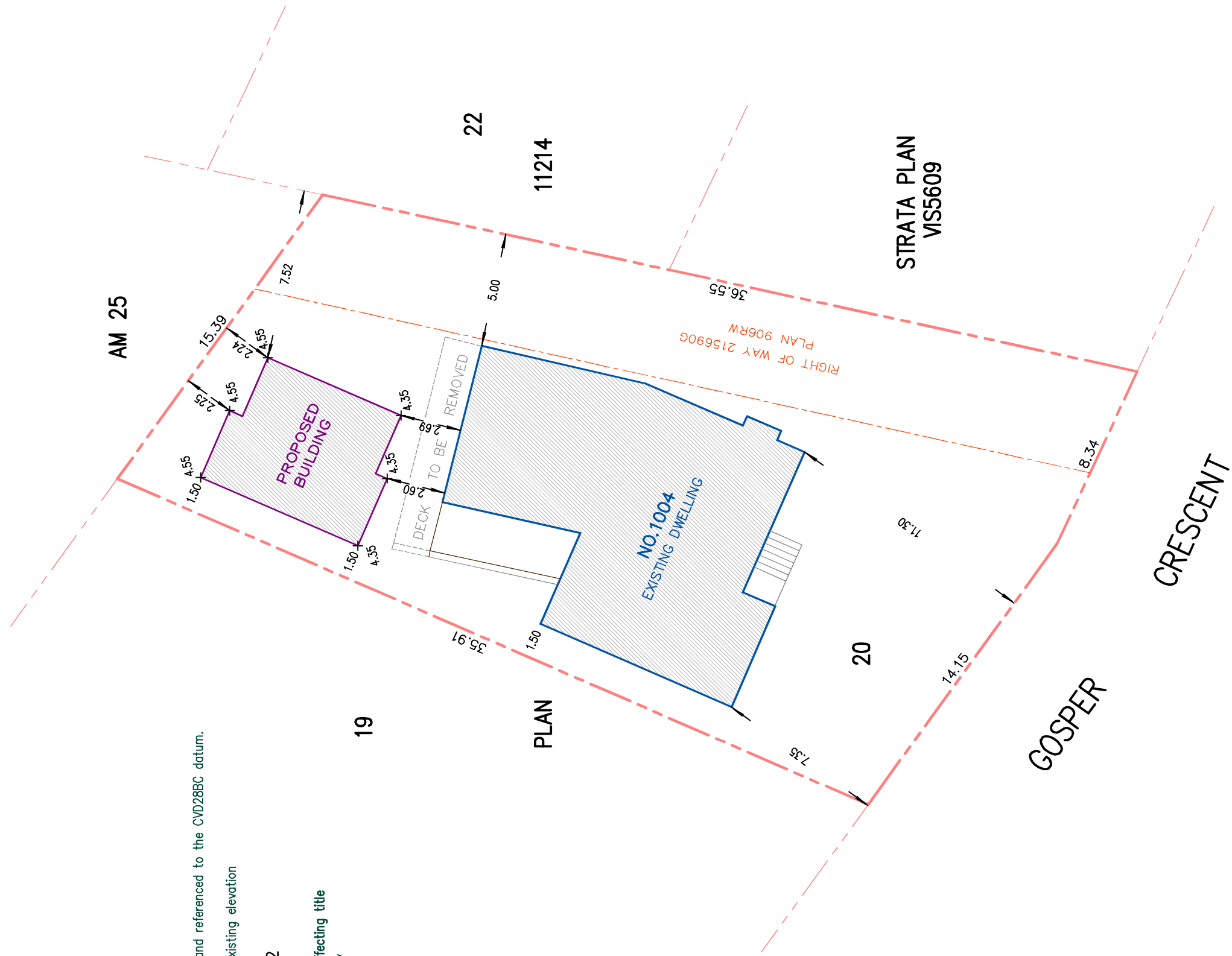

File: 12_999

Drawing: BCLS Site (2025)

V.I. Powell & Associates

Land Surveying

250-2950 Douglas Street

Victoria, BC, V8T 4N4

250-382-8855



CERTIFIED CORRECT
dated this 11th day of February, 2026

April Larocque

Signed with Certified (2025/02/11)
Verify with verifio.com or Adobe Reader.



B.C.L.S

Setbacks are derived from field survey.
Parcel dimensions shown hereon are
derived from Land Title Office records.

This document shows the relative location
of the surveyed features and shall not be
used to define property boundaries.

April Larocque
This document is not valid unless digitally signed.