



**CORPORATION OF THE TOWNSHIP OF ESQUIMALT**

**STREETS AND TRAFFIC REGULATION BYLAW, 2017, No. 2898**

**ORDER NO. 1338**

**WHEREAS I, JOEL CLARY**, Director of Engineering and Public Works of the Corporation of the Township of Esquimalt, am empowered under the terms and provisions of the *Streets and Traffic Regulation Bylaw, 2017, No. 2898* to make orders in respect of certain matters and things therein mentioned.

**NOW THEREFORE** in the exercise of the powers given in the said By-law, **I DO HEREBY ORDER THAT:**

“Residential Parking Only” signage be installed on both sides of Joffre St commencing 9m north from the intersection of Lyall Street and extending north to 9m south of Esquimalt Rd.

This Order to be effective and to come into full force and effect from midnight upon the 3<sup>rd</sup> day of October, 2022.

---

Director of Engineering and Public Works

I, **Deb Hopkins**, Corporate Officer of the Corporation of the Township of Esquimalt, **DO HEREBY CERTIFY:**

1. That the foregoing is a true copy of an Order made by Joel Clary, Director of Engineering and Public Works of the Corporation of the Township of Esquimalt, pursuant to the terms and provisions of the *Streets and Traffic Regulation Bylaw, 2017, No. 2898* of the said Corporation and submitted to the Municipal Council of the Corporation of the Township of Esquimalt on the 3<sup>rd</sup> day of October, 2022.
2. That on the 3<sup>rd</sup> day of October, 2022, the said Municipal Council did, by resolution, approve the said Order, the original of which is on file in my custody in the Municipal Hall of the Corporation of the Township of Esquimalt, pursuant to the terms of the *Streets and Traffic Regulation Bylaw, 2017, No. 2898*.

---

Corporate Officer

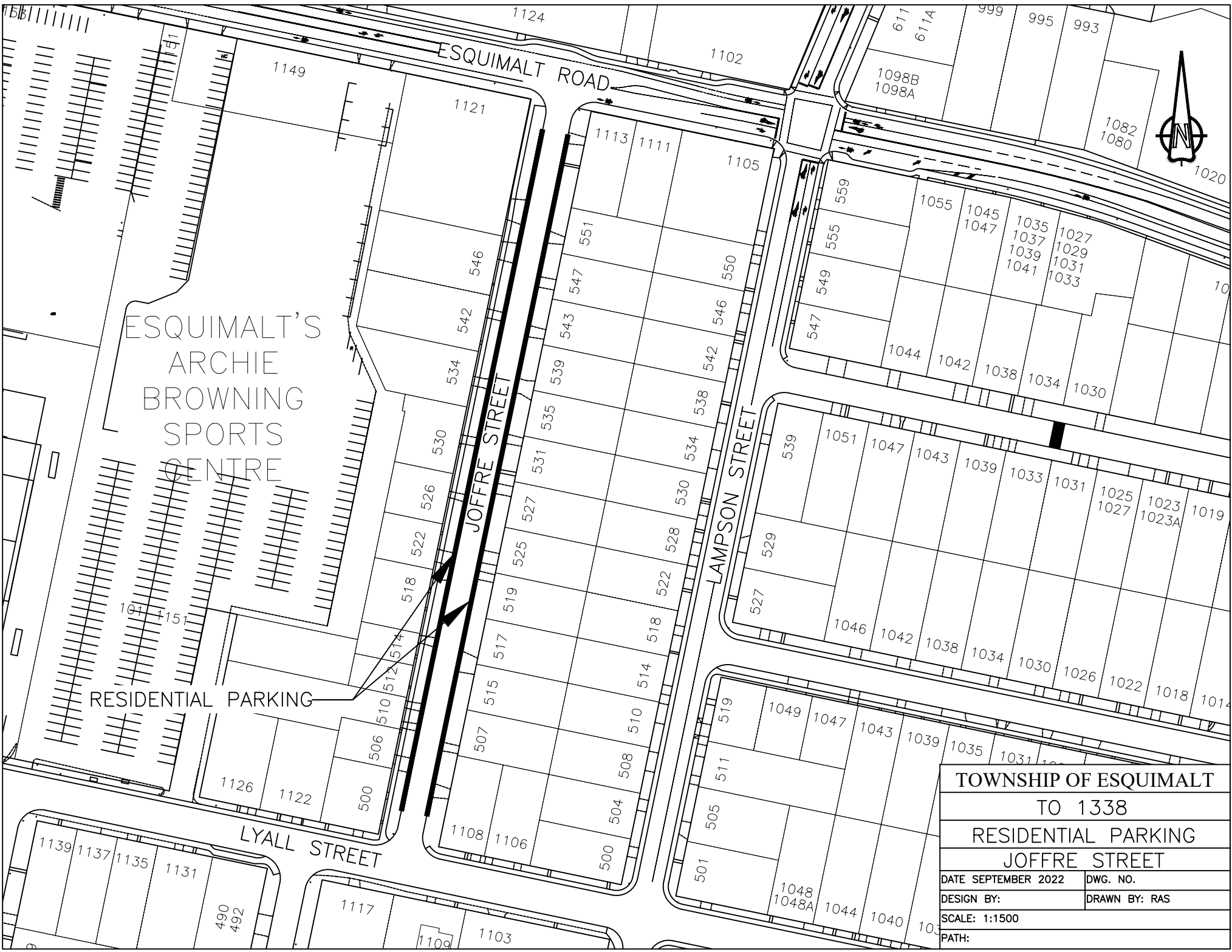

ESQUIMALT'S  
 ARCHIE  
 BROWNING  
 SPORTS  
 CENTRE

RESIDENTIAL PARKING

ESQUIMALT ROAD

JOFFRE STREET

LAMPSON STREET

LYALL STREET

TOWNSHIP OF ESQUIMALT  
 TO 1338

RESIDENTIAL PARKING  
 JOFFRE STREET

DATE SEPTEMBER 2022 DWG. NO.

DESIGN BY: DRAWN BY: RAS

SCALE: 1:1500

PATH:

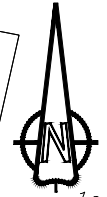

1149

1121

1124

1102

611  
611A

999

995

993

1098B  
1098A

1082  
1080

1020

1113

1111

1105

559

1055

1045  
1047

1035  
1037  
1039  
1041

1027  
1029  
1031  
1033

10

546

542

534

530

551

547

543

539

535

531

527

550

546

542

538

534

530

526

522

518

514

549

545

1044

1042

1038

1034

1030

539

1051

1047

1043

1039

1033

1031

1025  
1027

1023  
1023A

1019

529

1046

1042

1038

1034

1030

1026

1022

1018

101

101

1151

1126

1122

506

510

512

514

1108

1106

500

508

510

514

518

519

511

505

501

1049

1047

1043

1039

1035

1031

1027

1023

1019

1048  
1048A

1044

1040

1036

1139

1137

1135

1131

490  
492

1117

1109

1103