

**BC LAND SURVEYORS SITE PLAN
OF PROPOSED SUBDIVISION**

Civic: 1073 Colville Road

**Legal: Parcel A (DD 45859-W) of Lot 16,
Section 10, Esquimalt District, Plan 7328**

Parcel Identifier: 005-713-391
in the Township of Esquimalt
Lot Area = 906 m²

LEGEND

Elevations are to geodetic datum.
+ - denotes - existing elevation
○ - denotes - existing tree
Tree diameters are in centimetres.

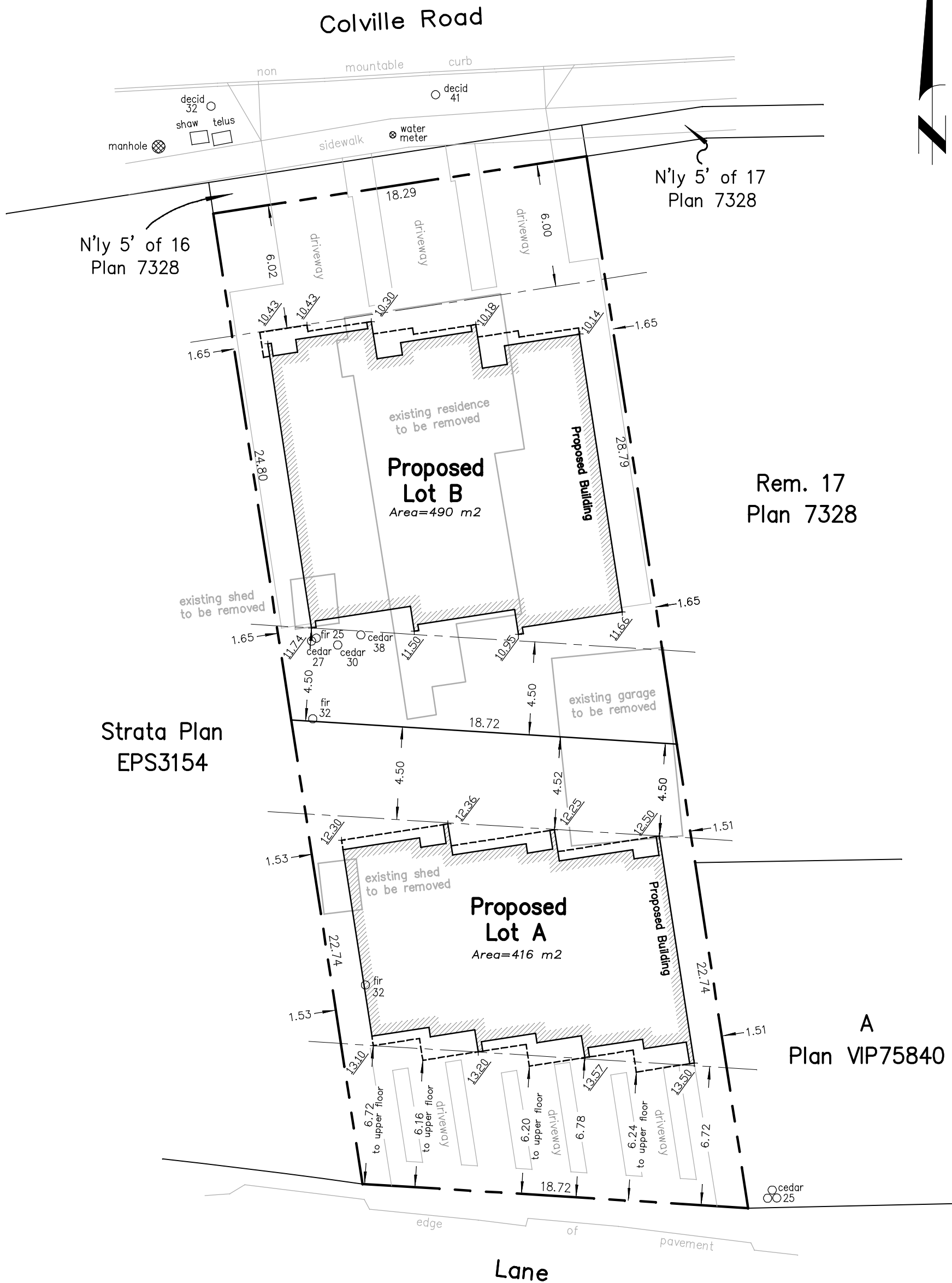

CERTIFIED CORRECT
This 10th day of October, 2024.

Scott T. Pearse, BCLS

SCALE 1 : 2 0 0



All distances are shown in metres.
Plot on 11" x 17" sheet.

Date	October 10, 2024
Drawing	3758 SUB PROP_03
File	13758-22
VI POWELL & ASSOCIATES Land Surveyors 250-2950 Douglas Street Victoria, BC V8T 4N4 phone (250) 382-8855	