

BC Land Surveyor's Site Plan of:
Lot 16 Block B, Section 11,
Esquimalt District, Plan 292, Except
Parcel A (DD 130301).
P.I.D.'s: 001-322-818 & 001-322-842

Civic Address: 527 Lampson Street



Scale = 1:200

Dated this 13th day of May, 2025.

Distances and elevations shown are in metres.

Elevations are based on geodetic datum CVD28BC
and derived from OCM 84H0162.

This site plan is for building and design purposes and is
for the exclusive use of our client.

This document shows the relative location of the surveyed
structures and features with respect to the boundaries of
the parcel described above. This document shall not be used
to define property lines or property corners.

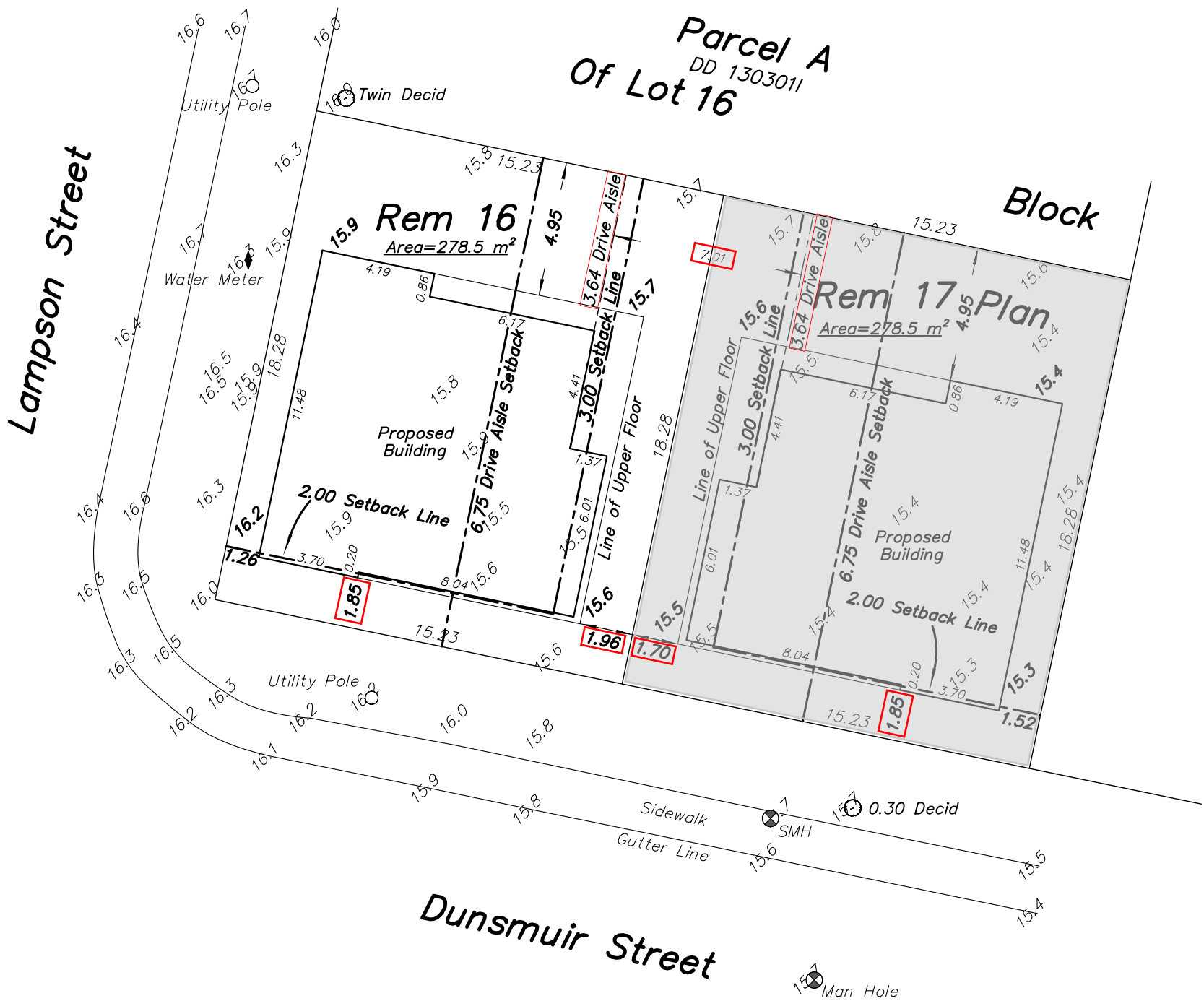
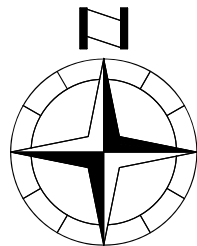

B
292
18

Wey Mayenburg Land Surveying Inc.

www.weysurveys.com

#4-2227 James White Boulevard
Sidney, BC V8L 1Z5
Telephone (250) 656-5155
File: 250108c\Sit\LE