

# BC LAND SURVEYORS SITE PLAN OF:

**Civic: 622 Admirals Road**  
**Legal Lot A, Suburban Lot 43,**  
**Esquimalt District, Plan EPP82555**

File	10349 - 19
Drawing	Site Plan- PROP BLDG
POWELL & ASSOCIATES B C Land Surveyors 250-2950 Douglas Street Victoria, BC V8T 4N4 Phone: (250) 382-8855	

Parcel Identifier: 030-615-992 in the Township of Esquimalt

Scale - 1:300 Distances are in metres.

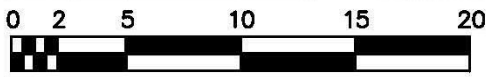

The intended print size is 11" by 17".

### LEGEND

- +xx.xx Existing geodetic elevations
- Balcony projection

Building Height Conformance	
Existing Average Grade	= 21.65m
Proposed Main Floor El.	= 22.05m
Proposed Roof Height	= 61.61m
Proposed Building Height	= 39.96m

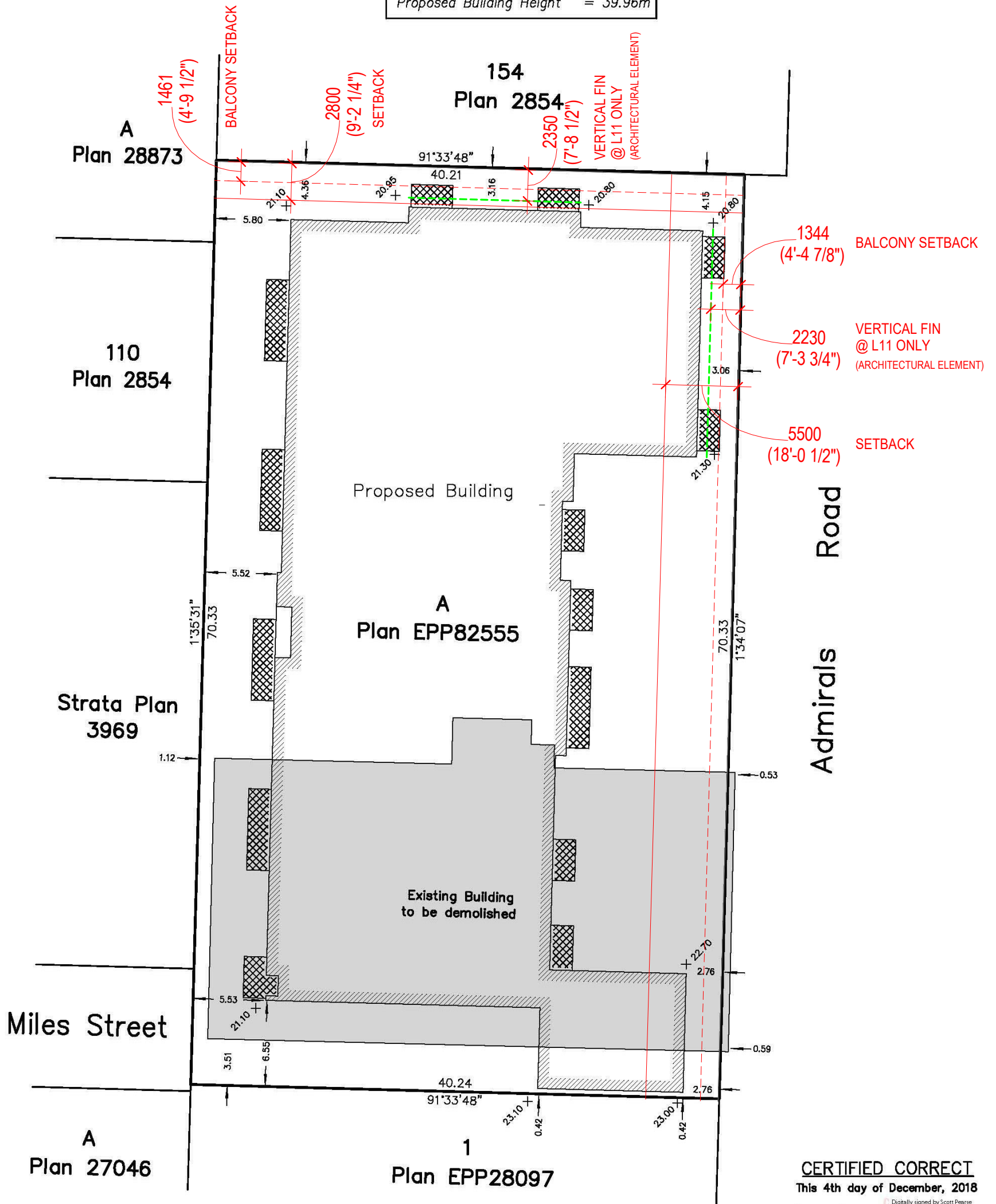

**CERTIFIED CORRECT**  
 This 4th day of December, 2018  
 Digitally signed by Scott Pearse  
 Scott Pearse  
 1BUGAM  
 Scott T. Pearse, BCLS